

No. of Contacts	DIMENSIONS	
	A	B
02	2.00	4.00
03	4.00	6.00
04	6.00	8.00
05	8.00	10.00
06	10.00	12.00
07	12.00	14.00
08	14.00	16.00
09	16.00	18.00
10	18.00	20.00
11	20.00	22.00
12	22.00	24.00
13	24.00	26.00
14	26.00	28.00
15	28.00	30.00
16	30.00	32.00
17	32.00	34.00
18	34.00	36.00
19	36.00	38.00
20	38.00	40.00
21	40.00	42.00
22	42.00	44.00
23	44.00	46.00
24	46.00	48.00
25	48.00	50.00
26	50.00	52.00
27	52.00	54.00
28	54.00	56.00
29	56.00	58.00
30	58.00	60.00
31	60.00	62.00
32	62.00	64.00
33	64.00	66.00
34	66.00	68.00
35	68.00	70.00
36	70.00	72.00
37	72.00	74.00
38	74.00	76.00
39	76.00	78.00
40	78.00	80.00

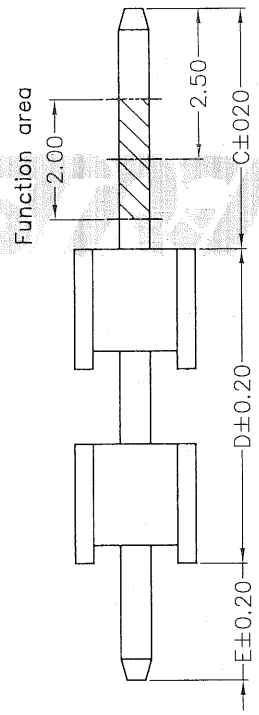
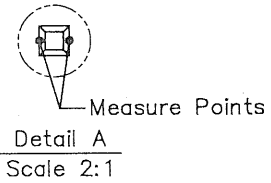
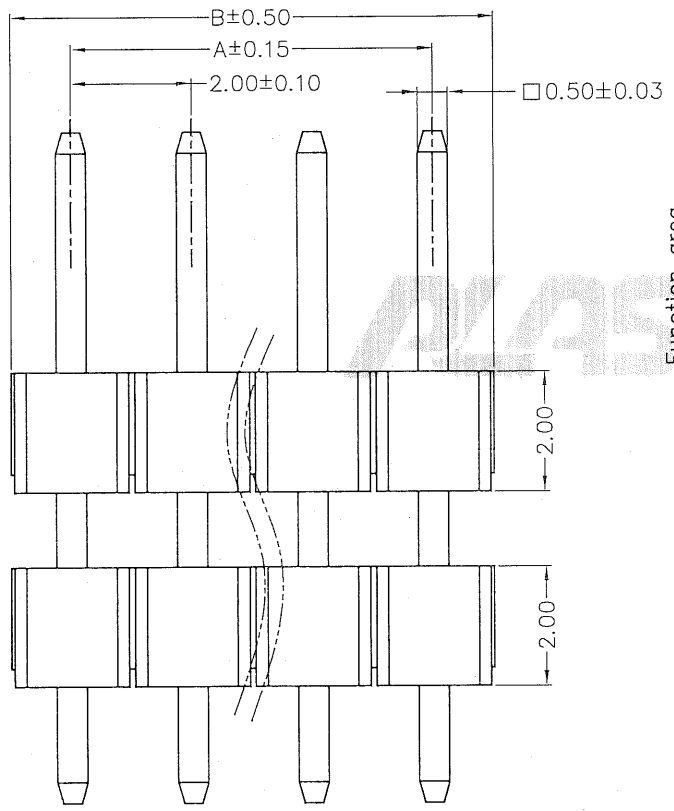
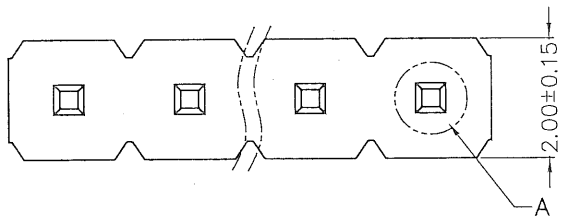

NOTES: (Unless otherwise specified)

- Dimension shall be interpreted per ANSI Y14.5M.
- Materials:
Insulator material: Thermoplastic, UL 94V-0; Color: Black.
Contact material: Copper Alloy
- Current Rating: 2A Per Pin.
- Voltage Rating: 30V AC/DC.
- Working Temperature: -40°C ~ +105°C.
- Harmful material should be compliant to doc. "EI-0005" standards.
- Product number matrix:

Pin Type	Code
Brass	L
Bronze	B
Phosphor Bronze	P
⊙ Standard: L	

XE-XX-X-C/D/E-X

- NULL: Thermoplastic
- F: High Temperature Thermoplastic
- H: Halogen Free
- Pin Length mm

Contact Plating	
Definition	Code
⊙ Tin plated	A
⊙ Gold plated:	
flash B 15u"	F
10u" E 30u"	J
⊙ Duplex plated:	
flash K 15u"	P
10u" N 30u"	U
⊙ Standard: B	
All plating is lead free	

Number of Contacts

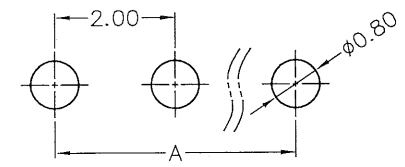

版次	ECN 编码	描述		设计/日期
17	CW11040187	改前	改后	严胜旺_2011/04/27
		/	增加无卤编码	
18	EL21120158	/	更换新图框	刘恋_2021/12/29



TOLERANCE TABLE		SCALE	DRAWN	DATE	DWG. NO.	TITLE	REV.
X. ± 0.30	X.° ± 3°	8:1	刘恋	2021/12/29	600-0000-0325	CUSTOMER DRAWING	18
X. ± 0.25	X.° ± 2°	UNIT mm	CHECK 李晨博	2021/12/31	PARTS NO.(INTENDED USE)		SHEET 1/1
.XX ± 0.20		SIZE A4	APPROVE 刘恋	2021/12/31	XE-XX-X-C/D/E-X		